

Towing eyes 40mm

ROE57374

Towing eyes according to DIN 74054-40A pressed-in replaceable towing eye sleeve 40 mm inner diameter

Part number ROE57374
 D-value 125kN
 Weight 5kgs
 Down load 250kgs
 Approval Number ECE E1 55R-01 2203

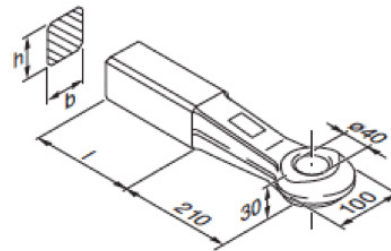

H	B	L
65	57	125

Towing eyes 50 mm

ROE57272

Towing eyes according to DIN 74053 pressed-in replaceable towing eye sleeve 50 mm inner diameter

Part no. **ROE57272**
 Material: heat-treated steel St 52-3
 D-value: 190 kN
 Weight: 10.3 kgs
 Down Load: 1000 kgs
 Approval Number ECE E1 55R-01 2335

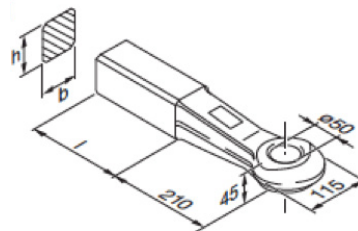

H	B	L
65	60	170

ROE57005 c/w solid bush

Part no. **ROE57005**
 Material: heat-treated steel St 52-3
 D-value: 314kN
 Weight: 13.4 kgs
 Down Load: 1000 kgs

D-value is reduced to 190kN with 100 kgs down load.

Approval Number ECE E1 55R-01 2146

