



Montage- und Betriebsanleitung

D

Installation and operating instructions

GB

Instructions de montage et d'utilisation

F

ROCKINGER

Member of JOST-World

Modellreihe

Series

Type

RO*56 E

RO*561 E

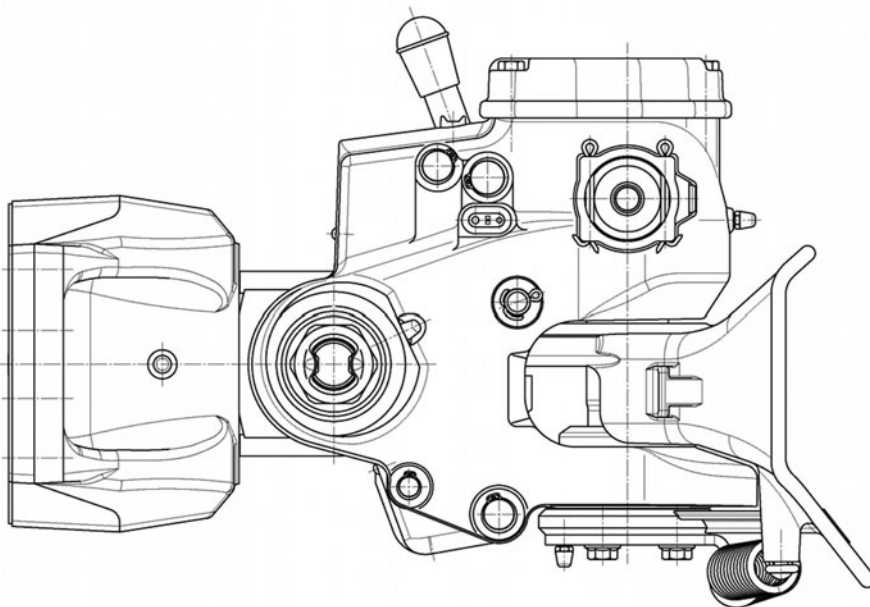

Series RO*56 E / RO*561 E

Fully automatic tow hitch

e1*94/20*1630-00 / e1*94/20*1631-00

Only in conjunction with:

- 50 mm ROCKINGER towing eye RO*57005 Class D (EC)
- or in values and dimension of equivalent towing eyes



The hitch must be fitted by qualified personnel.

Read these instructions carefully before fitting.

Note:

When fitting the towing hitch, the EC directive 94/20, in particular annex VII, as well as the relevant national regulations must be observed.

The installation and operation instructions must be kept in the vehicle.

Subject to technical changes without prior notice.

1. Installation 14 – 15

1.1 Before installation 14

1.2 Installation of the hitch 15

2. Operation 16 – 17

2.1 Tow hitch 16

2.1.1 Hitching 16

2.1.2 Unhitching 17

3. Maintenance 18

3.1 Care 18

3.2 Inspection 18

Technical data 19 – 21

Retrofit kit 21

Inspection 22

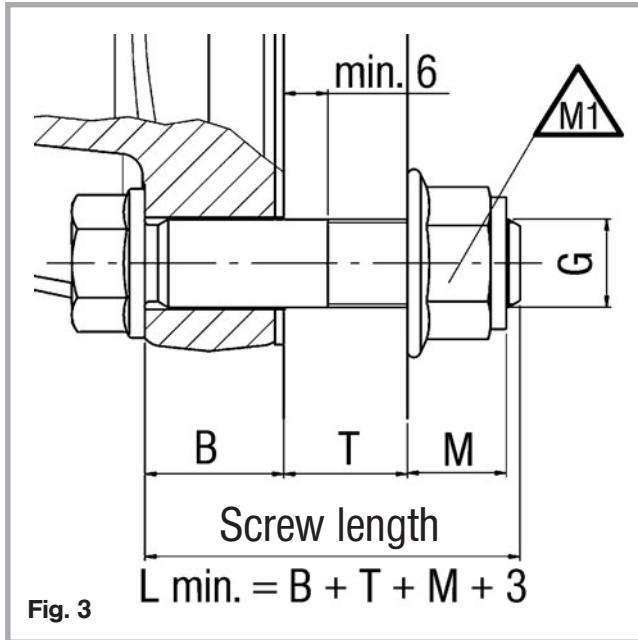

Fig. 3

1.2 Installation of the hitch RO*56E

- Put the fully preassembled tow hitch in place with the rear side of the fastening bracket on the cross member and bolt it tight to the cross member with the fastening bolts.

RO*56E (Fig. 3)

- Use 10 x shaft screws $G = M 16 \times 1.5 - L - 10.9$ with flange locking nuts $M 16 \times 1.5 - 10$.

Tightening torque **300 + 30 Nm**

The installation on the vehicle must be documented (see section: Inspection).



RO*561E (Fig. 3)

- Use 4 x shaft screws $G = M 20 \times 1.5 - L - 10.9$ with flange locking nuts $M 20 \times 1.5 - 10$.

Tightening torque **570 + 20 Nm**

The installation on the vehicle must be documented (see section Inspection).



Attention: The shaft section of the fastening bolt must project at least 6 mm into the cross bar.

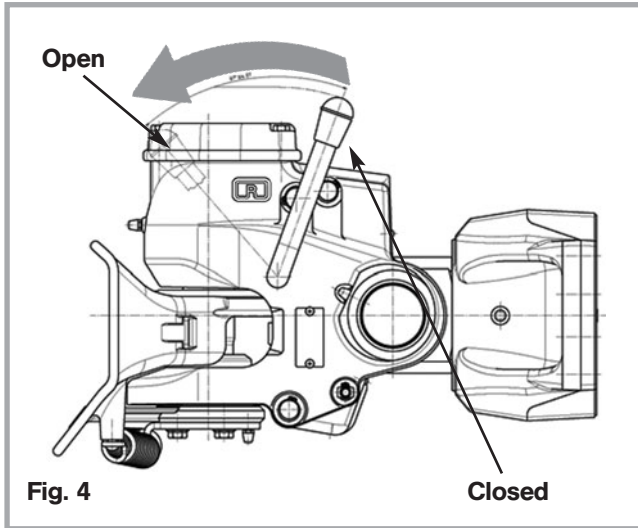

2.1 Tow hitch

On hitching and unhitching the applicable regulations (e.g. employer's liability insurance etc.) must be observed.

Do not stand between the vehicles!

2.1.1 Hitching

- Pull the hand lever **H** forwards until it engages.
- Check that the coupling jaw is **locked**.
- Release the brake on the front axle of the articulated drawbar trailer.
- Reverse the towing vehicle slowly.

Check

After each coupling-up procedure, it is essential to check that the coupling is correctly closed and locked.

The control pin must not protrude out of its guide after coupling-up (see fig. 5)

If the lock-control pin protrudes from its guide (in the dark detectable by touching it), the coupling procedure has been carried out incorrectly and there is the **risk of an accident!**

Driving a trailer in that condition is not allowed.

If not correctly coupled:

- move the towing vehicle forward (approximately 1 m)
- **check again**

In-cab status indicator upgrade kit available for retrofitting.

Coupling open!

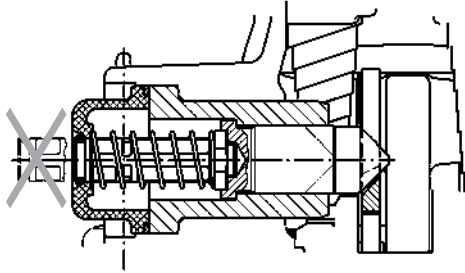

O.K.

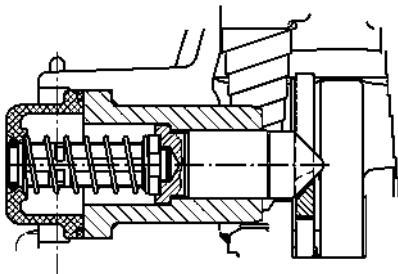

Fig. 5

Closing hitch manually

- Swing the hand lever **H** back (in the direction of the cross member)

2.1.2 Unhitching

- **Secure the trailer against rolling away!**
- Disconnect the supply lines to the trailer
- Pull the hand lever **H** forwards until it engages.

If there is tension between the tractor vehicle and the trailer, remedy this by jerking or with the aid of the pneumatic suspension.

- Separate the tractor vehicle

When the towing eye leaves the coupling, the coupling closes automatically

3.1 Care

- Before cleaning with a high-pressure washer, close the coupling
- Before initial operation and after prolonged usage or cleaning with a high-pressure washer, lubricate the coupling pin, the bearing surface for the lower bush and the towing eye with viscous, water-resistant grease (EP 3).
- Apply grease to the automatic system when changing the coupling pin.
- When changing the coupling pin remove all of the old grease and replace with multi-purpose grease (Lithium-based NLGI-2, temperature range -40 to +120 degrees).

3.2 Inspection

- After initial installation of the tow hitch, the fastening bolts must be checked and tightened as necessary. This must be documented.

For **inspection intervals and documentation** see Page 22.

- The coupling pin diameter may **not be less than $\varnothing 46.5$ mm** section. Otherwise the coupling pin must be replaced.
- Coupling pin height clearance **max. 3 mm**
- The internal diameter of the lower bush may **not be less than $\varnothing 47.1$ mm**
- The downwards opening **must be free.**

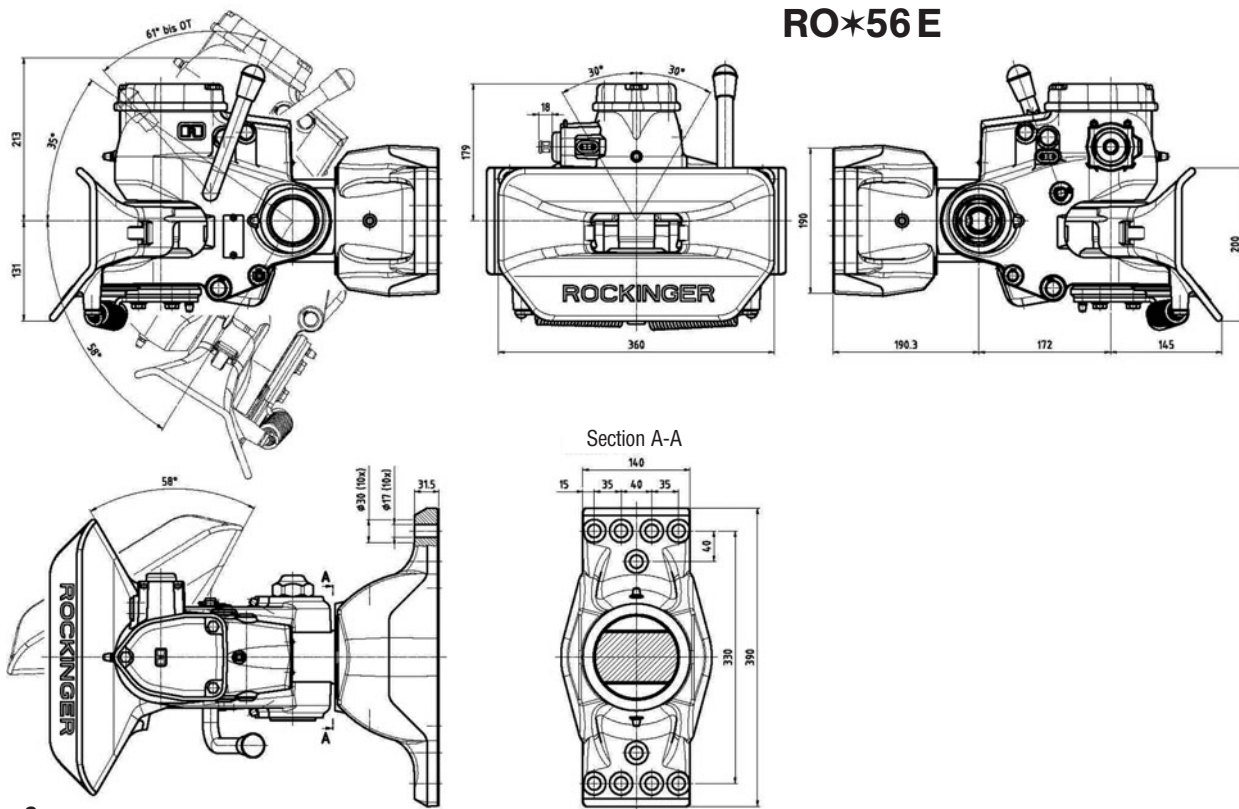

Fig. 6



RO*561E

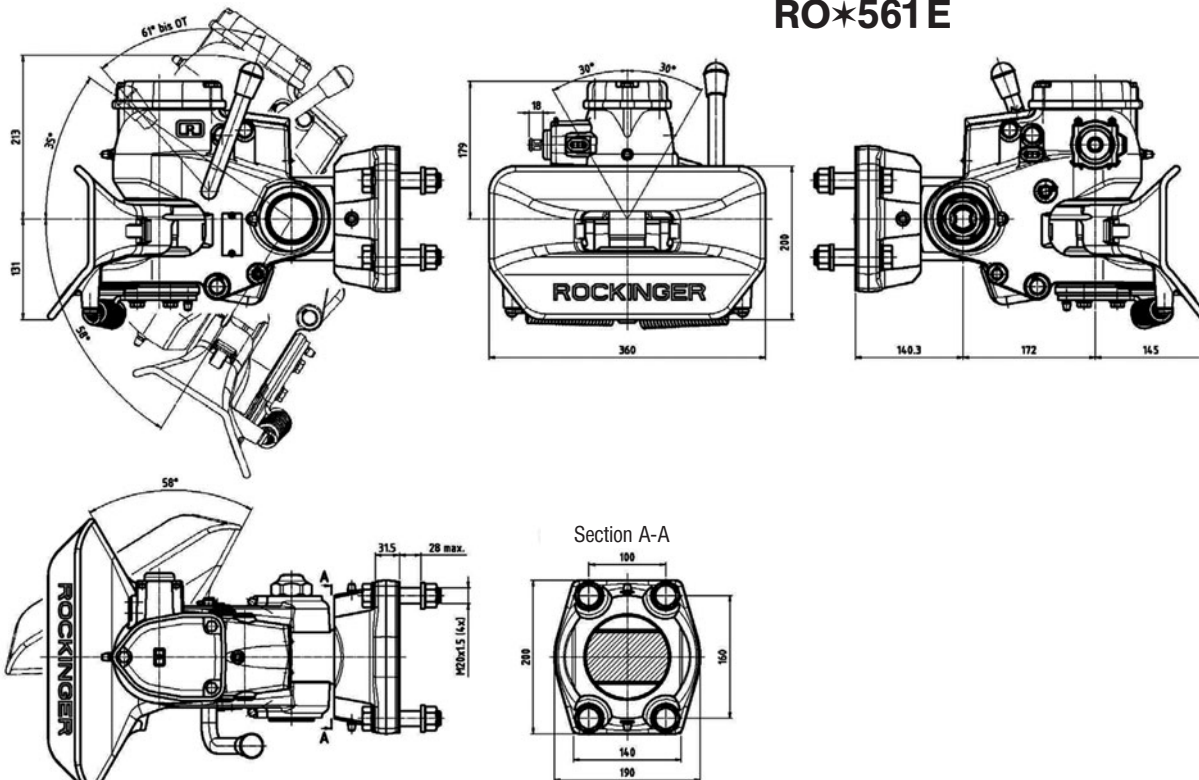

Fig. 7

Technical data

RO*56E/RO*561E

Article-number	Equipment	Hole pattern (mm)	Permissible D-value (kN)	Weight (kg)
RO567A80000	A	Special hole pattern (see Fig. 8)	314	81
RO567A66000	A	160x100	200	61

Equipment: A = hand lever upwards

B = hand lever downwards



Retrofit kit

RO*56E/RO*561E

Remote indicator

Article no.

Electronic remote indicator

ROE 71546

Display in driver's cab

Extension cable 15 m

2x sensor

Inspection of the fastening bolts

Truck kilometres	Interval	M1 tightening torque of the fastening bolts / nuts checked		
		Date	Fitter's signature	Workshop stamp
	Initial installation			
	Installation km + 1,000 km			
	Installation km + 15,000 km			
	Installation km + 60,000 km			
	Installation km + 120,000 km			
	Installation km + 180,000 km			
	Installation km + 240,000 km			
	Installation km + 300,000 km			





ROCKINGER

JOST-Werke · Siemensstr. 2, D-63263 Neu-Isenburg · Telefon +49(0)61 02 295-0 · Fax +49(0)61 02 295-298 · www.jost-world.com

ZDE 199 88243-0-01 · 01/2007